

7 UHQFK 026 %DUULHU 6FKRWWN\ 5H

TSP L300P6

Features

SMP6

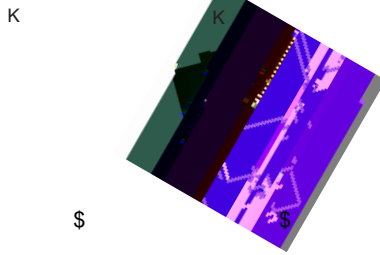

Applications

Cathode K ◯ ← ◯ Anode A

Maximum ratings and electrical characteristics (TJ = 25°C unless otherwise noted)

				0			
				0 50			
7\SLFDO WKHUPDO UHVLVWDQFH SHU GRRJH DRXQWHG RQ)5		3 & %					
				MAX.			
1				1		0.76	
1						-	
5		7- f &		4		0.90	
5				8		-	
				1		20	
				2			

(1) Pulse test: 300 μs pulse width, 1 % duty cycle

(2) Pulse test: Pulse width 0.40 ms

RATINGS AND CHARACTERISTICS CURVES (TA = 25 °C unless otherwise noted)

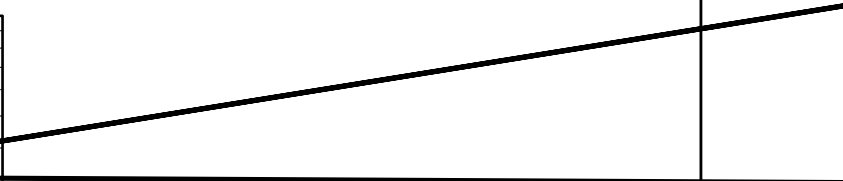
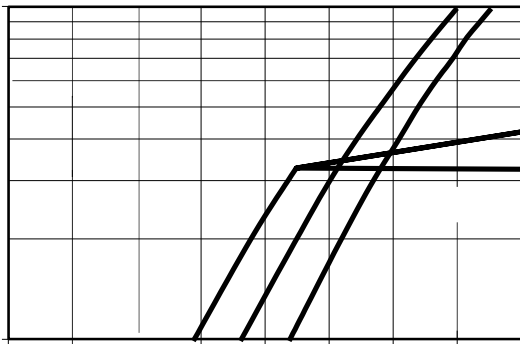
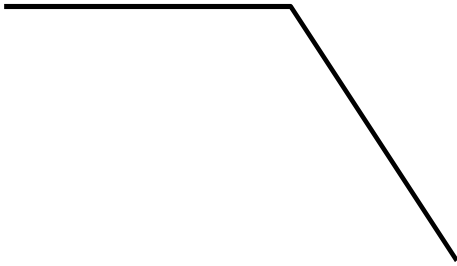

PACKAGE OUTLINE DIMENSIONS

SMP6

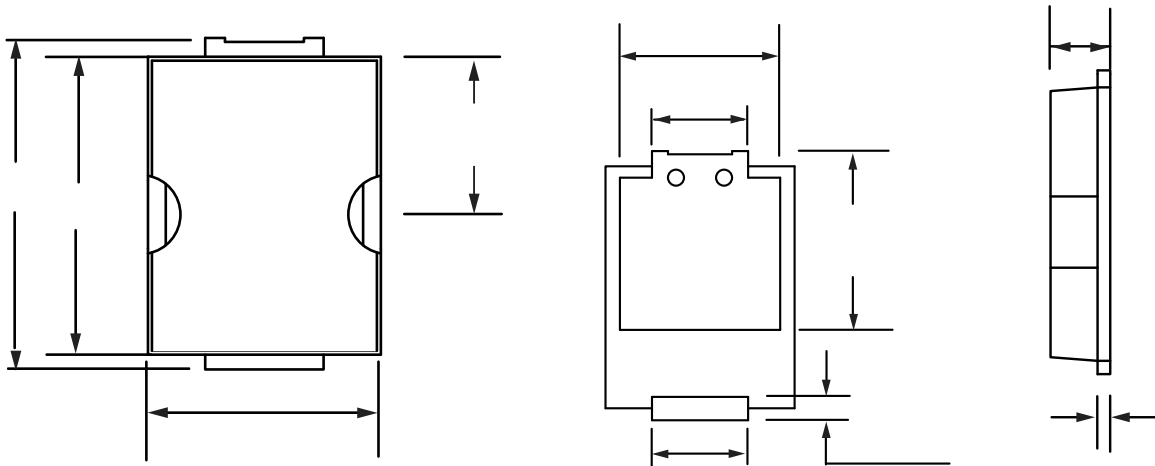

SMP6 mechanical data

SMP6 Suggested Pad Layout

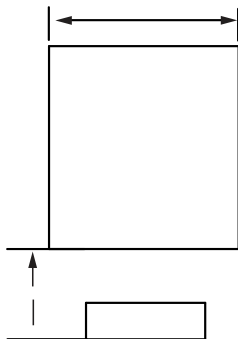

UNIT		L	M	N	O	
mm	min	5*			.4	
{ a}						