

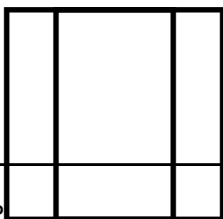

RATINGS AND CHARACTERISTICS CURVES

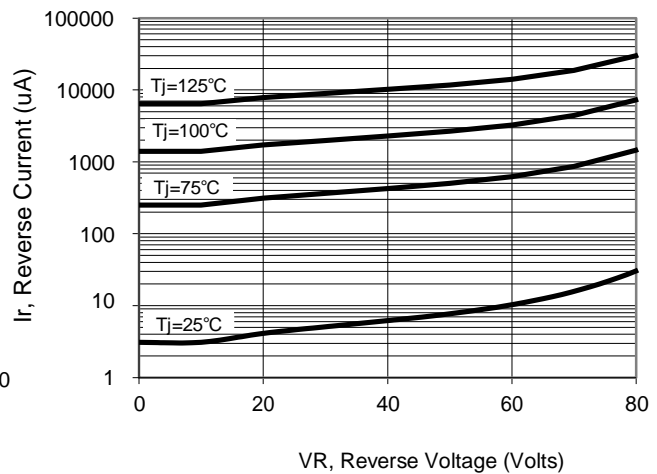

PACKAGE OUTLINE DIMENSIONS

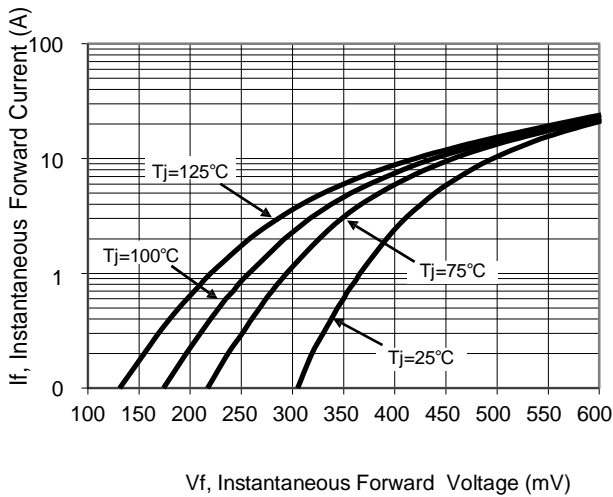
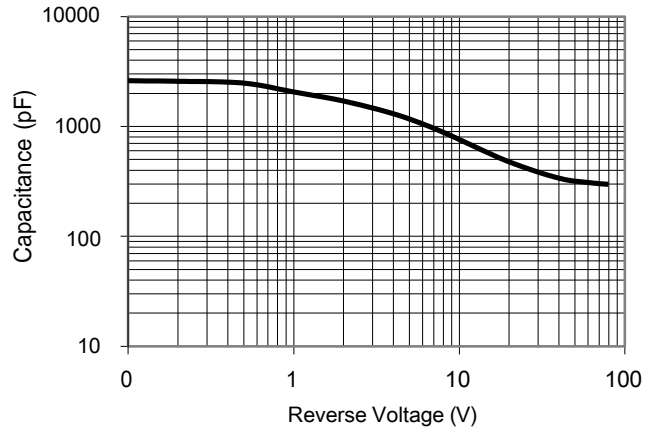
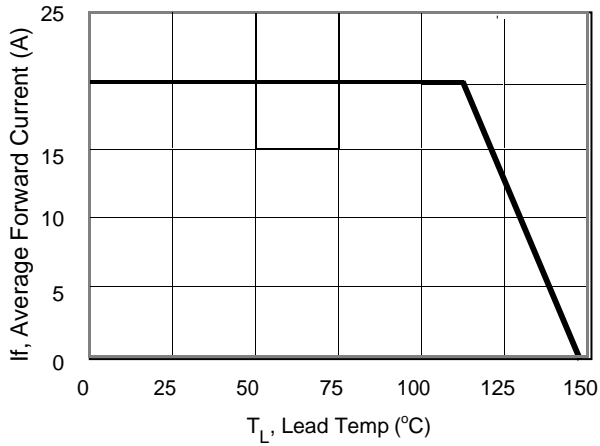
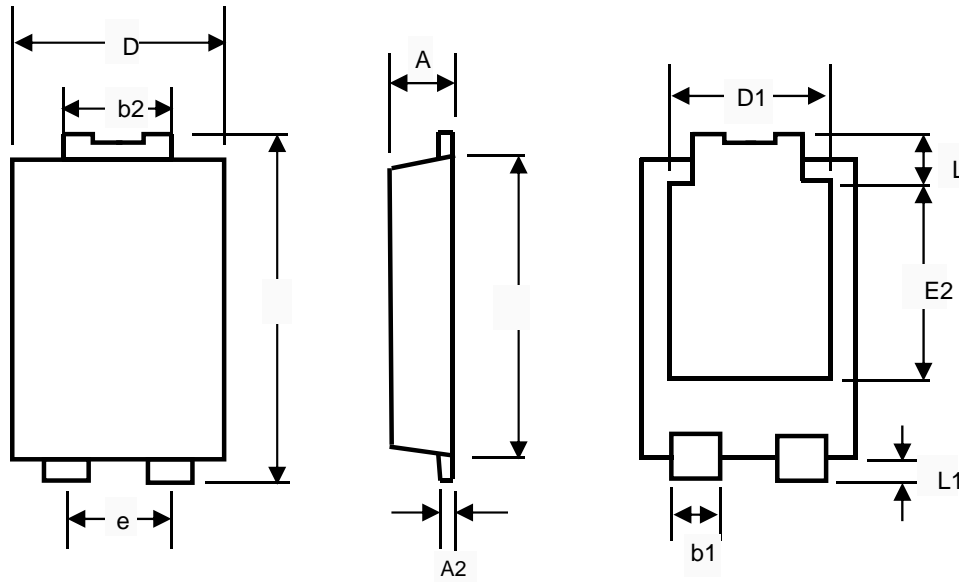

TO-277 mechanical data

UNIT		A										
mm	max	1.	0.									0.
	min	1.	0.2								0.	0.
mil	max	51.18	15.75	39.37	74.80	169.3	120.0	259.8	226.3	139.7	39.37	27.55
	min	43.30	7.87	31.49	66.93	153.5		252.0	208.6		31.49	19.69

Suggested Pad Layout

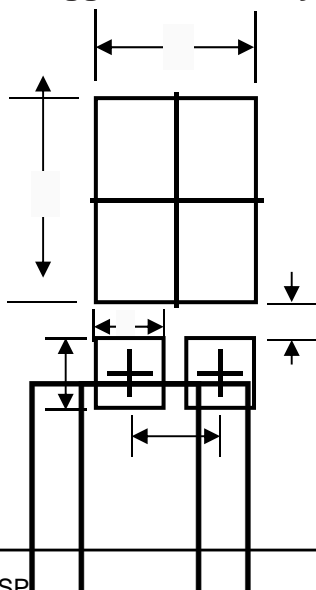

UNIT							
mm	min	.0	.0	.			
mil	min				35.43		

Marking Information

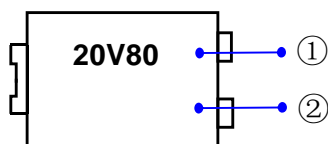

① Product model :TSP20V80SP Referred to as 20V80

② PDC information

Y X WW

WW:Week code(01 to 53)

X:Internal identification code

Y:Year code(ex:0=2020)

Packaging Information

1.Reel Dimensions

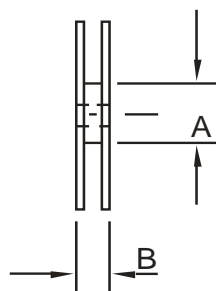
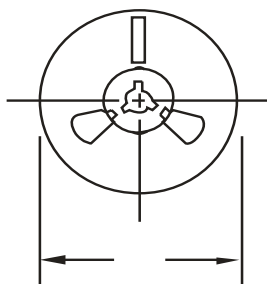

2. Inside Box

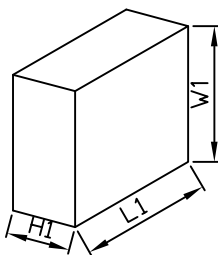

3. Outside Box

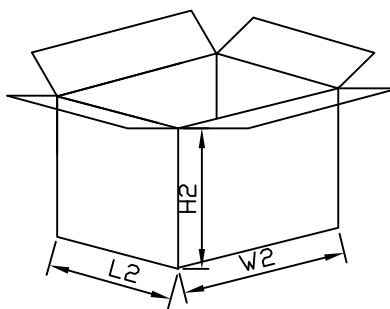

Packaging Information

NO	UNIT	Reel Dimensions			Inside Box			Outside Box		
		φ	A	B	L1	W1	H1	L2	W2	H2
Size	mm	330	70	15	335	335	43	360	360	360
QTY	PCS	Smallest package,5000PCS/reel			10,000PCS,2 reel in total			80,000PCS/carton, boxes in total		
Note		Tolerance 20mm,±3mm; 21-100mm,±5mm; 101-500mm,±10mm								